

6

5

4

3

2

1

REVISION

ZONE	REV	DESCRIPTION	DATE	CHANGED BY	APPROVED
	1	PRELIMINARY RELEASE	10/10/2024	SLI	SXU

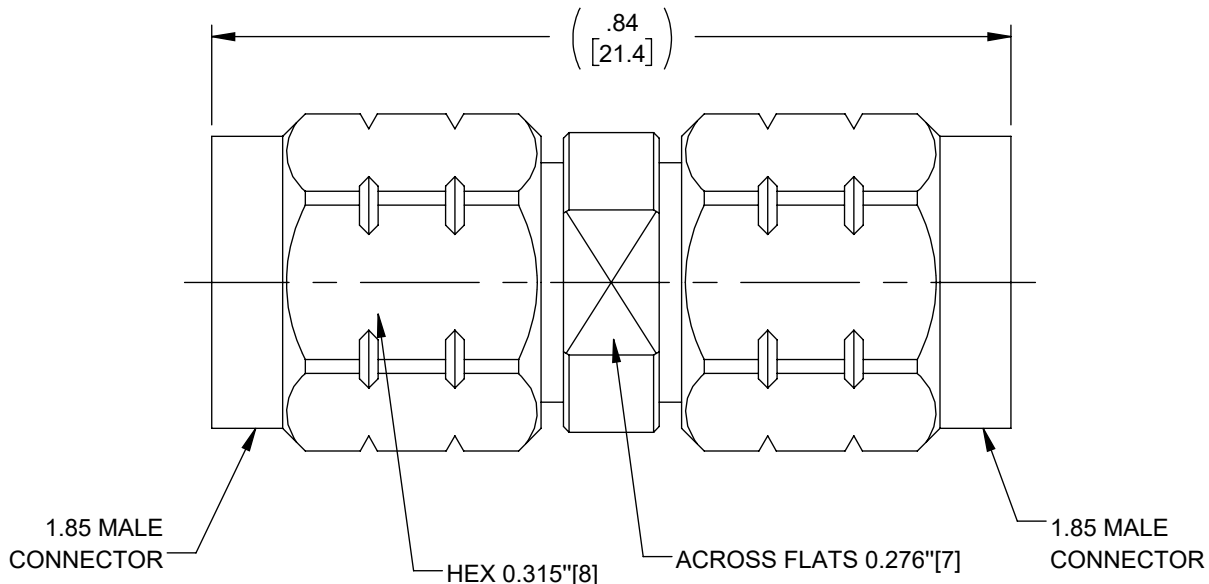

NOTES:

- MATERIALS AND FINISHES:
BODY - STAINLESS STEEL, PASSIVATED
OUTER CONTACT - STAINLESS STEEL, PASSIVATED
INNER CONTACT - BERYLLIUM COPPER, GOLD PLATING
INSULATOR - PEI
- ELECTRICAL
IMPEDANCE: 50 OHM
FREQUENCY RANGE: DC - 67 GHz
VSWR: 1.25 MAX. @DC - 67 GHz
INSERTION LOSS: 0.1XSQRT[F(GHz)]dB MAX.
VOLTAGE RATING: 500 VRMS
DIELECTRIC WITHSTANDING VOLTAGE: 2000 VRMS MIN.
INSULATION RESISTANCE: 5000 MOHMS MIN.
- MECHANICAL
DURABILITY: 500 CYCLES MIN.
TEMPERATURE RANGE: -40 TO 85°C
COMPATIBLE WITH ALL STANDARD: IEC 61169-32

UNLESS OTHERWISE SPECIFIED
LEADING DIMENSIONS ARE INCHES
DIMENSIONS IN [] ARE MILLIMETERS

TOLERANCES:

.X = ±.2 [5] FRACTIONS
.XX = ±.02 [.5] ± 1/32
.XXX = ±.005 [.13] ANGLES ± 1°

CABLE LENGTH TOLERANCES:

≤12 [305] = +1 [25] / -0
>12 [305] ≤ 60 [1524] = +2 [51] / -0
>60 [1524] ≤ 120 [3048] = +4 [102] / -0
>120 [3048] ≤ 300 [7620] = +6 [152] / -0
>300 [7620] = +5% / -0

ALL DIMENSIONS ARE FOR REFERENCE ONLY
AND SUBJECT TO CHANGE WITHOUT NOTICE.



Website: www.Pasternack.com
Phone: 1.866.727.8376 | 1.949.261.1920

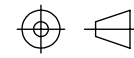

INTERPRET ALL DIMENSIONS AND
TOLERANCES PER ASME Y14.5

SCALE

NONE

SHEET

1 OF 1

DESCRIPTION

1.85 male to 1.85 male 67GHz Adapter

SIZE

A

CAGE CODE

53919

DRAWN BY

SLI

ITEM NO.

PECCN008

REV

1

THE INFORMATION CONTAINED IN THIS DRAWING IS THE SOLE PROPERTY OF INFINITE ELECTRONICS, INC. ANY REPRODUCTION IN
PART OR WHOLE WITHOUT THE WRITTEN PERMISSION OF INFINITE ELECTRONICS, INC. IS PROHIBITED.
THESE COMMODITIES, TECHNOLOGY OR SOFTWARE WERE EXPORTED FROM THE UNITED STATES IN ACCORDANCE WITH THE
EXPORT ADMINISTRATION REGULATIONS. DIVERSION CONTRARY TO U.S. LAW PROHIBITED.

6

5

4

3

2

1