

MATERIALS

BODY	BRASS WHITE BRONZE PLATED
CONTACT	SILVER PLATED
INSULATOR	PTFE

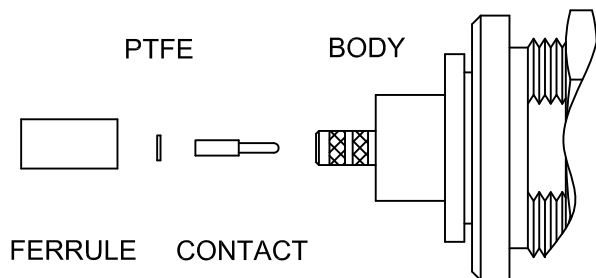
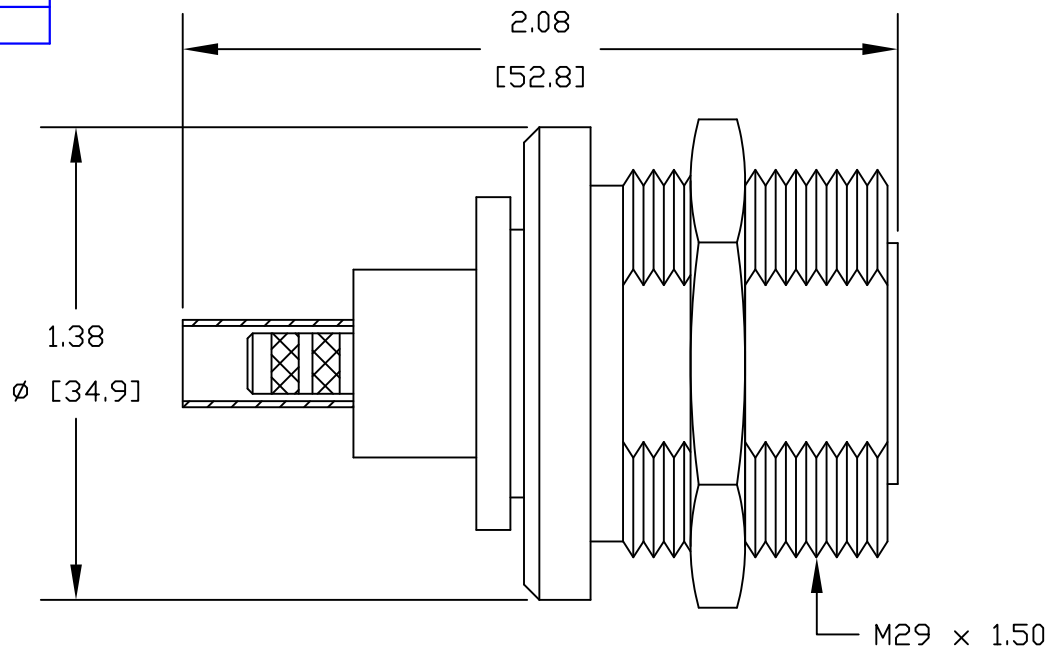

ASSEMBLY PROCEDURES

1. STRIP CABLE AS SHOWN. SLIDE PTFE OVER CENTER CONDUCTOR.
2. SOLDER CONTACT TO CENTER CONDUCTOR. SLIDE FERRULE OVER CABLE.
3. INSERT CABLE AND PARTS INTO BODY, PUSH CABLE UNTIL CONTACT SEATS IN PLACE.
4. SLIDE FERRULE OVER BRAID AND UP AGAINST BODY. CRIMP FERRULE.

CRIMP SIZE REQUIRED

CONTACT: SOLDER
FERRULE: .213" HEX CRIMP TOOL

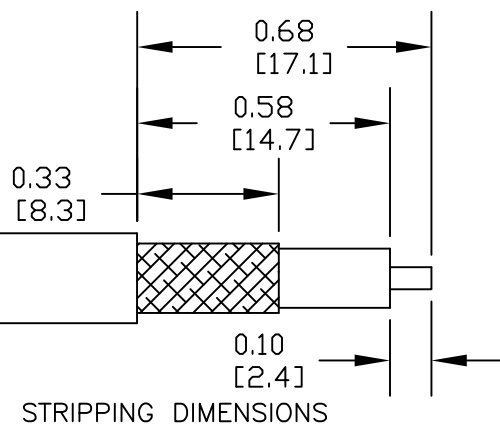

PASTERNAK ENTERPRISES, INC.

P.O BOX 16759, IRVINE, CA 92623
PHONE (949) 261-1920 FAX (949) 261-7451

WEB ADDRESS: www.pasternack.com
E-MAIL ADDRESS: sales@pasternack.com

COAXIAL & FIBER OPTICS

DWG TITLE

PE44656

DES.

7/16 FEMALE, BULKHEAD, CRIMP
ATTACHMENT FOR RG55; RG142; RG223 &
RG400

REV. A

FSCM NO. 53919

CAD FILE 081911

SCALE N/A

SIZE A 2231

NOTES:

1. UNLESS OTHERWISE SPECIFIED ALL DIMENSIONS ARE NOMINAL.
2. ALL SPECIFICATIONS ARE SUBJECT TO CHANGE WITHOUT NOTICE AT ANY TIME.
3. DIMENSIONS ARE IN INCHES [mm].
4. FITS MIL-C-17 AND EQUIVALENT CABLES.